

INSTRUCTIONS FOR PONDMASTER 190®

ITEM # 02019

The pondmaster 190 is a complete pond filtering system. It contains a biological and mechanical filter plus an integrated submersible mag-drive pump. A bonus mini-aquabelle fountain has been included. The versatile design allows the pondmaster to be an effective, easy to use filter. It can be used in shallow as well as deep ponds. The modular pump is easily removed for easy periodic cleaning. The pondmaster 190 has 2 layers of filtering media that combine to filter both mechanically and biologically. The top foam layer and the bottom coarse white layer combine to reduce ammonia and nitrites to harmless nitrates which are removed by aquatic plants and partial water changes. The filter is equipped with a submersible magnetically driven pump. It has no seals to wear out and contains no oil. The outlet has a 1/4" npt that will readily adapt to standard fittings. The included fountain will slip over the outside of the outlet.

SERVICE AND MAINTENANCE

Occasionally the pump impeller should be inspected and cleaned. Pull the pump out of the filter body. Remove the four screws which hold the pump cover to the housing. The impeller is the only serviceable item and can be pulled out of the body. Do not take the impeller apart. If it is worn or broken the entire assembly should be replaced. This will restore pump to original capacity. Do not overtighten screws when reassembling. Do not allow pump to run dry.

Use the handle to lift the filter from the pond. Do not use the cord to lift or move the filter. If you wish to place the filter in the middle of the pond tie a line to the handle and pull into place. To open the filter, lift the tab on the side opposite pump, lift the handle and slide the cover toward the pump to disengage from housing.

Keep in mind that the phosphates, which are present in many water supplies, joined with the increased biological load present in most man made ponds make an ideal breeding ground for algae. Decreasing the amount of bright sunlight your pond is exposed to and eliminating overfeeding of pond fish are two ways to help regulate algae growth. No mechanical filtering system alone will eliminate algae growth.

ALWAYS TURN OFF THE ELECTRICITY BEFORE CLEANING FILTER. LIFT THE FILTER FROM THE POND AND REMOVE COVER. BOTH FILTER MEDIA CAN BE EASILY REMOVED FROM FILTER AND QUICKLY RINSED. IF YOU WISH TO MAINTAIN THE BIOLOGICAL PROPERTIES DO NOT SOAK OR WASH THE PADS IN CHLORINATED WATER. USE WATER FROM THE POND. WHEN THE PADS START TO MAT DOWN OR THE FOAM PAD FLAKES AND TEARS IT SHOULD BE REPLACED.

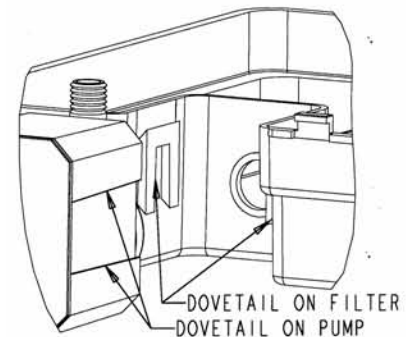

ELECTRICAL PRECAUTIONS

Always use a properly grounded outlet. Do not immerse plug in water. **DO NOT REACH INTO WATER TO REMOVE PLUG. TURN OFF CIRCUIT FIRST.** A "drip loop" should be provided. The "drip loop" is a loop in the cord below the level of the receptacle or plug that prevents water from traveling along the cord. The National Electric Code requires that a ground fault circuit interrupter (GFCI) be installed in the branch circuit supplying fountain or pond equipment. Your dealer can supply GFCI units. **NEVER REMOVE GROUND PIN FROM PLUG. WARNING; FOR YOUR PROTECTION ALWAYS UNPLUG THE UNIT FROM ITS POWER SOURCE BEFORE INSTALLING OR SERVICING. SHOULD THE UNIT APPEAR TO BE NOT WORKING DO NOT REACH, REMOVE OR DISASSEMBLE UNIT BEFORE YOU DISCONNECT POWER.** The pump is intended to pump water only. It cannot be used to pump oils, solvents, or gasoline.

**CAUTION: PONDS CAN BE DANGEROUS TO SMALL CHILDREN.
NEVER LEAVE CHILDREN UNSUPERVISED NEAR A POND.**

OPTIONAL TIPS FOR CONNECTING PUMP

The pump included with the pondmaster190 will pump up to 190 gals per hour.

If you chose not to use the aquabelle fountain, a 1/2" id tubing will fit over the nozzle. This can power a statue or waterfall.

There are a number of things which will reduce the flow of a pump:

- ◆ Dirty or clogged filter.
- ◆ Small diameter hose (do not use a 1/2" id hose over 6' long).
- ◆ FLOW THROUGH 15' OF 1/2" FLEX TUBING IS REDUCED TO 160 GPH @ ZERO HEAD.
- ◆ The height the water is pumped. (measured from the pond surface to the discharge of the hose.)
- ◆ If you must connect to a small fitting on a statue. Reduce the size of the hose at the statue. Not at the pump end of the hose.

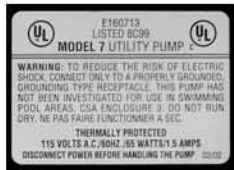
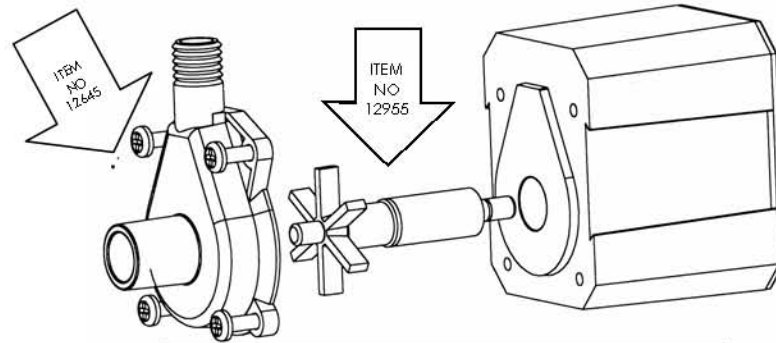
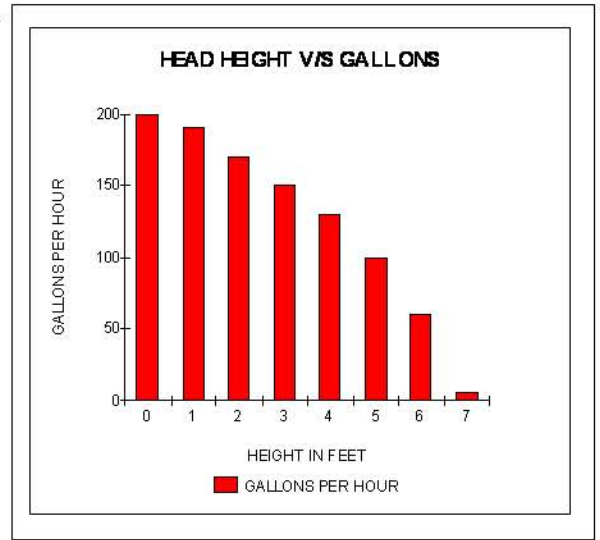

THIS LABEL NEAR ELECTRIC CORD CONTAINS MODEL AND OTHER INFORMATION

ITEM No.	DESCRIPTION
12645	COVER/'O' RING
12955	COMPLETE IMPELLER
12195	FILTER PADS 3 PCS
02089	MINI-BELL FOUNTAIN

LIMITED WARRANTY

E.G. Danner Mfg. Inc. will repair or replace any pump found to be defective as follows: Pump body, cover and filter and accessories within three years of original purchase. Impeller and internal moving parts within one year of original purchase. This warranty does not cover any replaceable filtering material supplied with the pump or filter as it is considered expendable. Damaging, cutting or altering power cord, removing or defacing product labels voids any warranty consideration. For warranty repair return only the part that is defective to our factory. Please include a dated proof of purchase and \$5.00 for postage and handling. Damages or injuries resulting from negligence or misuse of the product are not covered by warranty. This warranty gives you specific legal rights. You may have other rights which vary from state to state.

DANNER MFG. INC. 160 OVAL DRIVE, ISLANDIA, NEW YORK 11749-1489
VISIT OUR WEB SITE: WWW.DANNERMFG.COM