

TORNADO II

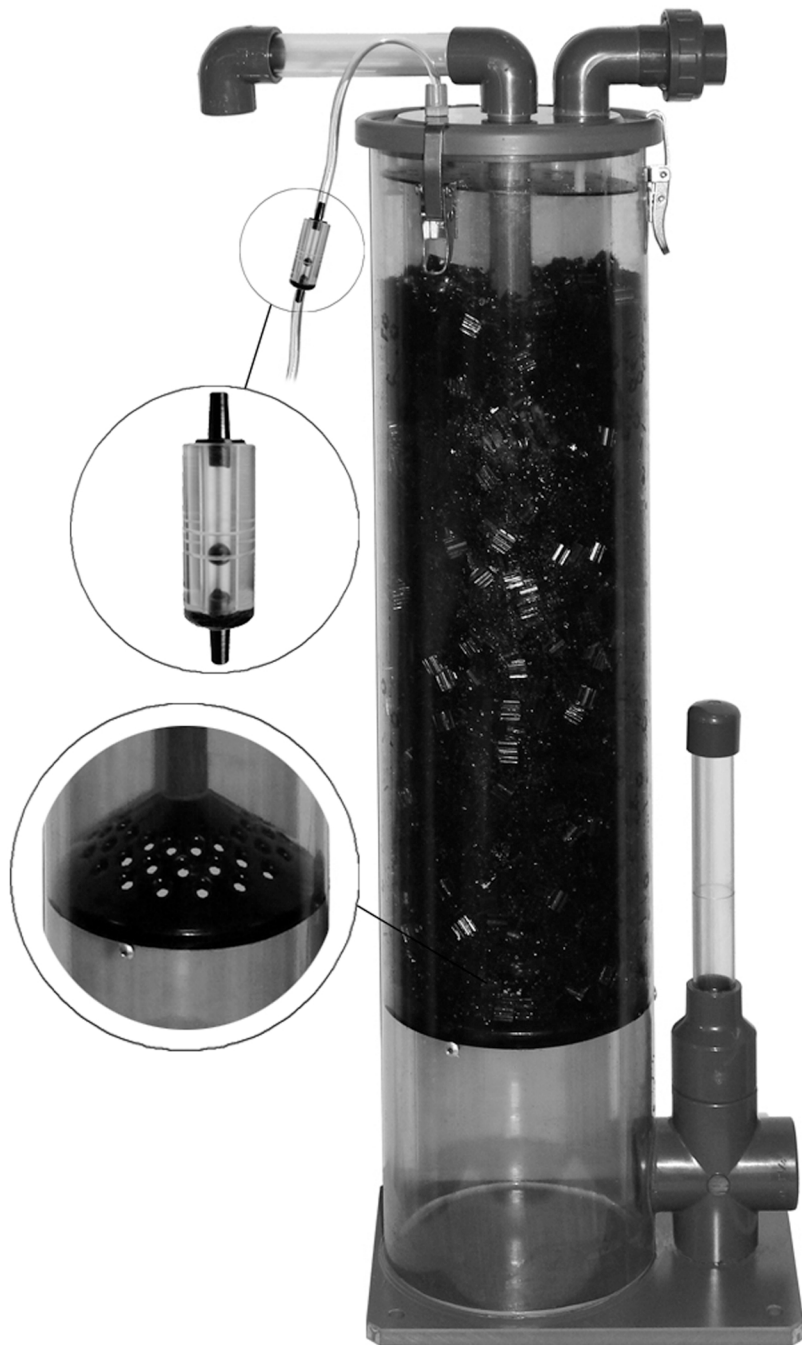

INSTRUCTION MANUAL GEBRAUCHSANWEISUNG GEBRUIKERSHANDLEIDING

Instruction manual AquaForte Tornado II

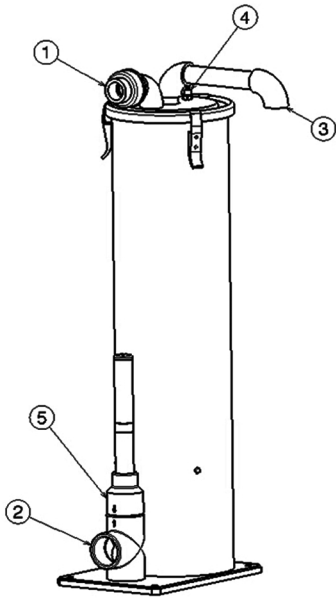

Positioning and connections

Put the filter as level as possible on a steady base. If needed the ground plate can be fixed with screws. Please note not too tighten the screws! Connect the fittings and check for water tightness.

- 1 Water inlet Ø25mm
- 2 Water outlet Ø40mm
- 3 Foam outlet Ø25mm
- 4 Air inlet Ø4/6mm
- 5 Adjustable valve for water flow

Maintenance

The various parts can be maintained as follows:

1. Pull off foam outlet (1)
2. Open the 3 stainless steel clamps
3. Remove lid with perforated plate (2)
4. Remove bio rings
5. Pull out pipe with cone (3)
6. Pull out adjustable valve by gently turning it around

Clean O-rings and lubricate them with some Vaseline at re-installation

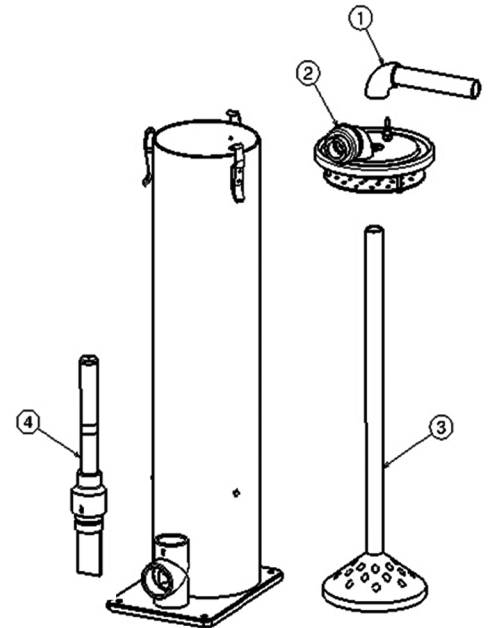

Settings

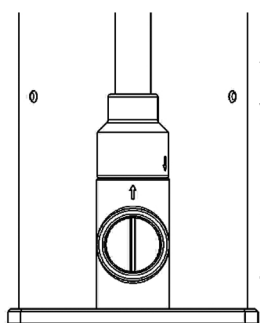

Valve open
Valve at 90° position (left/right) maximum flow

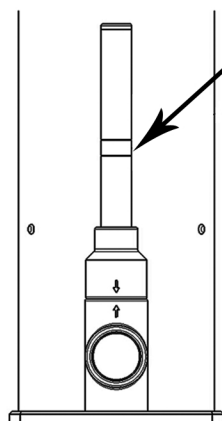

Adjustment range

The water pump must have a flow of 2-4m³/h. The flow must be adjusted to keep the water level within the range of the level indication.

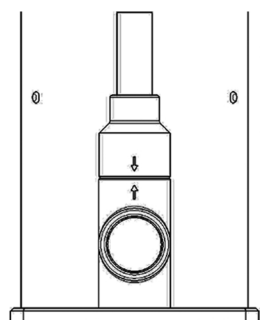

Valve closed
Indication marks in opposite positions Minimum flow

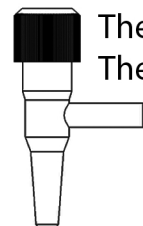

The air flow must be within 20-30 l/h. The air valve must be adjusted to keep the ball inside the flowmeter within the **marked range**.

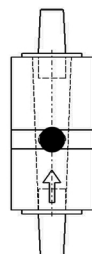

The air flowmeter is only used for first use and for checkups. It does not need to be installed permanently for normal use, as condensated water can settle out and obstruct its performance.