

# PONDMASTER®

SAVE THESE  
INSTRUCTIONS

## SUBMERSIBLE LED POND LIGHT

### CARE AND OPERATING INSTRUCTIONS

02387 Single Light set with transformer  
02389 Triple Light set with transformer



**WARNING!** PONDS ARE DANGEROUS TO SMALL CHILDREN!  
NEVER LEAVE CHILDREN UNSUPERVISED NEAR A POND.

### BEFORE YOU BEGIN: Read and Understand these Important Safety Instructions

**Caution:** To guard against injury, basic safety precautions should be observed, including the following:  
**Always unplug to disconnect power before servicing light.**

**Danger: Risk of Electrical Shock;** This light has not been investigated for use in, and is not to be used in swimming pools.

**Warning: Electrical Precaution;** To reduce the risk of electrical shock, connect only to a properly grounded, grounding type receptacle. The National Electric Code (NEC), Article 680-41(A) requires ground fault circuit interrupter (GFCI) be installed in the branch circuit supplying fountain equipment. Only a 3-wire grounding extension cord and grounded outlets should be used. If the extension cord plug can reach the water and be accidentally submerged it should be secured to prevent submersion.

**WARNING! DO NOT SUBMERSE TRANSFORMER IN WATER**

### Limited Warranty

E. G. Danner Mfg. Inc. will repair or replace any submersible pond light found to be defective within one year of purchase. For warranty repair the light unit must be returned to our factory. Please include dated proof of purchase. Damages or injuries resulting from negligence or misuse of this product are excluded from this warranty. This warranty gives you specific legal rights and you may also have other rights which vary from state to state.

ZG390 revA 7/15

### Parts

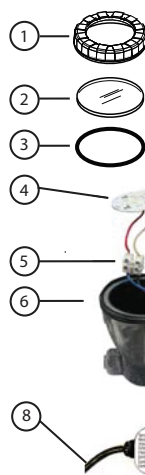

#### # Part description

1	Lamp Bezel
2	Lens
3	O-ring
4	LED Cluster
5	Terminal Block
6	Lamp Housing
7	Base
8	Transformer

Item #12330  
Replacement LED  
Lamp with "O" Ring

Must be positioned with clear  
window facing up

### Electrical Connections

Connect the cable(s) from Pond Light(s) to either the single or triple connection interface located on the cable coming off the transformer:

- Insert the pins completely into the connector
- Secure the connection by tightening the threaded collar onto threaded end of the connector

Before final placement, test the lamps by connecting to power source briefly. Once tested, before enabling the power to the transformer:

- Position all lamps as desired.
  - Verify that lamp is fully attached to the transformer.
  - Check that transformer is connected to a GFCI protected outlet.
  - Make sure that the power supply is rated 120 volts, 15 amps.
- Enable power to the transformer. If the lamp fails to light, check that the switch on the GFCI is in the "Powered" position.



### LED Cluster Replacement

The LED must be replaced only with Pondmaster Replacement LED Cluster - Item # 12330 Replacement Lamp with "O" Ring.

1. Unplug the light(s) from the 120 volt outlet.
2. Remove the bezel by turning it counterclockwise.
3. Remove the plastic lens.
4. Turn the housing upside down and tap against the palm of your hand until the L.E.D. cluster plate loosens & falls out.
5. Using a small screwdriver, open the 2 screws on the L.E.D. Cluster side of the terminal block.
6. Remove the 2 wire leads attached to the L.E.D. Cluster plate. Do not open the 2 screws of the terminal block located on the housing side.
7. Insert the 2 leads of the new L.E.D. Cluster plate into the holes of the terminal block and re-tighten.
8. Install L.E.D. Cluster plate back into housing.
9. Check that the "O" ring is still in place before placing plastic lens back into housing.
10. Re-install plastic lens.
11. Screw bezel back onto housing in a clockwise direction. Be sure to tighten Bezel enough to engage "O" Ring or water will penetrate housing.



DANNER Mfg. INC. • Islandia, New York 11749-1489  
631-234-5261 • Visit our web site at [www.dannermfg.com](http://www.dannermfg.com)