

Hudson Automatic Water Fill Valve

Installation Instructions

PACKAGE INCLUDES:

- Fill Valve
- Slide Plate with thumbscrew and 2 bolts
- Instructions for Use



CARE AND MAINTENANCE

- Regular pond maintenance such as removing debris from the skimmer basket/net will help the WFFV operate more efficiently.
- Winter preparation – The WFFV will not operate during extended freezing temperatures. Simply turn off the water supply to the unit and disconnect 1/4" tubing from the WFFV. To remove tubing from the quick connect fitting, hold in the socket on the fitting and pull tubing out.
- Float must be in a flat vertical position to work.

NOTE

- Easy to Install, takes only a few minutes!
- Maintains a ponds proper water level
- Plastic housing protects float
- For use with Aquascape Designs' skimmers

Features

The **Hudson WFFV** includes fittings to connect to a 1/4 inch poly tubing. The 1/4 inch poly tubing can be trenched over to a standard water spigot or connected to an irrigation system by a professional irrigation specialist.

Installing the Hudson WFFV

Tools needed for installation:

- 5/32 inch drill bit
- Phillips head screwdriver
- Adjustable wrench

Parts list for the WFFV System

- Fill valve with quick connects installed
- Slide Plate with thumbscrew and 2 bolts
- Brass Quick Connect Water Spigot Fitting (sold separately, #07000).

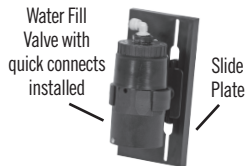

- 1/2" to 1/4" Irrigation Conversion Kit. Allows WFFV to be connected to irrigation line. (sold separately, #827807)
- 1/4" x 100' Poly tubing (sold separately, #29470)

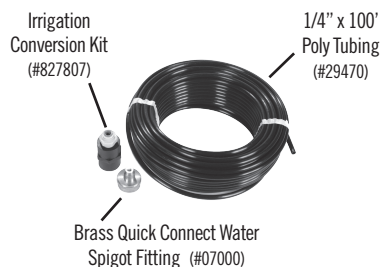

Skimmer Installation

- 1) Measure down 3" inches from the top of the Signature and Classic series for proper hole location. The second hole should be 1" over.
- 2) Drill two 5/32" holes at the locations marked.
- 3) Hold the WFFV with slide plate assembly to the inside of the skimmer and thread the two screws from the outside through the holes drilled.
- 4) Lay the tubing through the cord relief and insert into the quick connect fittings. *For Classic series, drill a 9/32" hole in the back wall to run the tubing through.* Leave extra tubing inside the skimmer for adjustments. To remove tubing from the quick connect fitting, hold in the socket on the fitting and pull tubing out.
- 5) Bury the 1/4" poly tubing to water spigot and connect using adaptor.

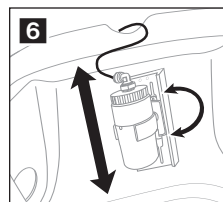
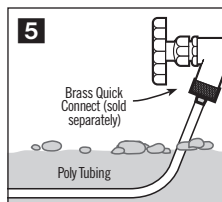
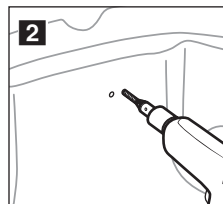
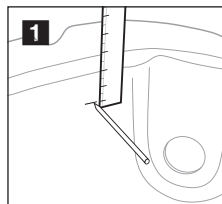
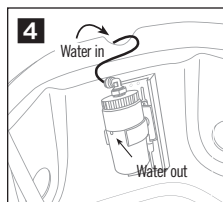
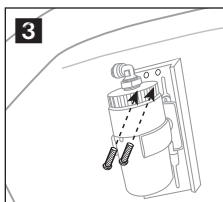

- 6) Adjust the WFFV. Final adjustments to the fill valve should be made while the pump is operating and the water in the pond is at the desired level. Simply loosen the thumbscrew and slide the unit up or down until the valve shuts off at the desired level. The valve will shut off 3/4"-1" from the bottom of the valve depending on pressure. **Note:** *There will be a short delay in shut off the first time the valve is used while the control chamber fills with water.* Retighten the thumbscrew.

MicroSnorkel™ Installation

- 1) On the outside of the MicroSnorkel™, measure 2" down and at least 1" over for proper location. The second hole should be 1" over. (Picture with slide plate)
- 2) Drill two of 5/32" holes at the location marked.
- 3) Hold the slide plate assembly to the inside of the MicroSnorkel™ and thread the two screws from the outside through the holes drilled.
- 4) Run the tubing through the pipe discharge and insert into the quick connect fitting. To remove tubing from the quick connect fitting, hold in the socket and pull the tubing out.
- 5) Bury the 1/4" poly tubing to water spigot and connect using adaptor.

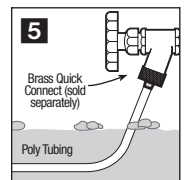
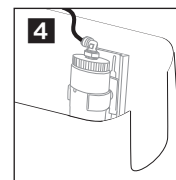
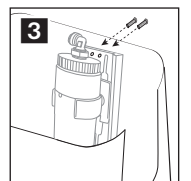
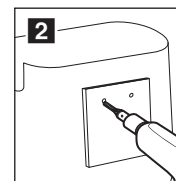
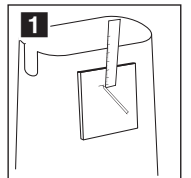

Made in USA for
Aquascape, Inc.
St. Charles, IL 60174 • Brampton, ON, L6T 5V7
www.aquasapedesigns.com