

**SAVE THESE
INSTRUCTIONS**

ProLine™

By **PONDMASTER®**

PRO 1000 & 2000 WATERFALL CARE AND OPERATING INSTRUCTIONS

MODELS with 8" Spillway

	UPC#
Pro1000 Waterfall Box	02477
Pro1000 BioMatrix Filter & Falls	02478
Pro1000 Filter & Falls with Debris Filter	02479

MODELS with 11¹/₄" Spillway

Pro 2000 Waterfall Box	02467
Pro 2000 BioMatrix Filter & Falls	02468
Pro 2000 Filter & Falls with Debris Filter	02469



ITEM 02477
SHOWN

WARNING! PONDS ARE DANGEROUS TO SMALL CHILDREN! NEVER LEAVE CHILDREN UNSUPERVISED NEAR A POND.

1. CONGRATULATIONS!

Thank you for purchasing your new Pro1000 or Pro2000 Water Falls. You now own one of the most versatile waterfall units ever designed. It has a number of features that set it apart from the rest:

- (1) Sturdy molded plastic construction
- (2) Compact capacity for minimal turbulence and room for biological filtration media
- (3) Assorted fittings with connectors. Models vary.
- (4) Biological filtration models feature either polyester Debris Filter Pads or BioMatrix biological filter media in a convenient open mesh media bag to biologically treat your pond
- (5) 1 Year Limited Warranty

Both the Pro1000 and Pro2000 Water Fall units are designed to be strong enough to resist collapsing from the pressure of soil and water around them, even when empty. They easily support the weight of stones placed on the upper rim to conceal it. The large capacity of the Waterfall Box means it will hold more filter media, providing greater surface area for bacterial colonization, and therefore more filtering capacity. The large multiple flat surfaces front and back also accommodate a large range of fitting options for maximum versatility in plumbing.

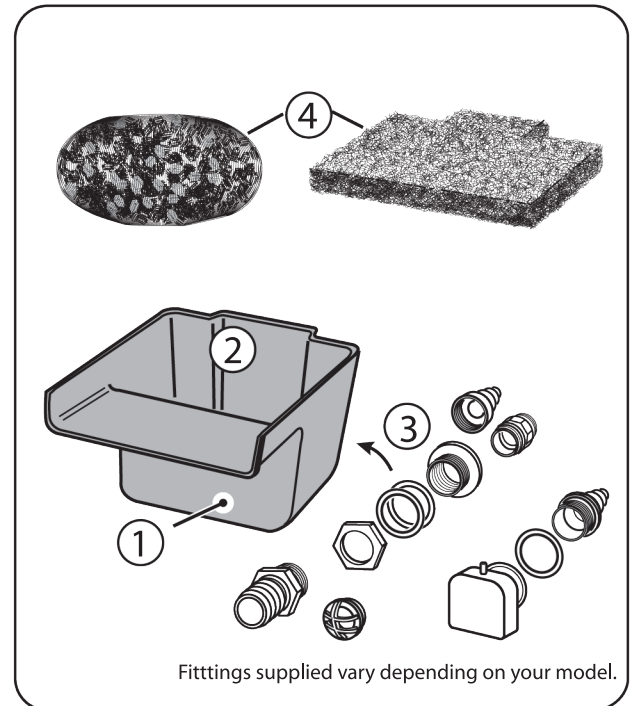

2. HOW BIOLOGICAL FILTRATION WORKS in the Pro1000 and Pro2000 BioMatrix Filter and Falls:

Fish extract nutrition from what they eat and excrete what's left back into the water column in the form of ammonia, which can be very toxic even at low concentrations. Your Biological Filter and Falls is specifically designed to maximize the natural processes that remove ammonia from the water. Water pumped into the Biological Filter and Falls brings the dissolved wastes into contact with bacterial colonies on the many surfaces of the filter media. These colonies digest, or metabolize, the ammonia. Some types of bacteria turn it into nitrites; others take the still toxic nitrites and dissolved oxygen and turn them into less toxic nitrates, a natural fertilizer that is easily taken up by plants. When the proper balance of fish, plants and aeration is reached, your Biological Filter and Falls will remove all of the ammonia and nitrite in your pond and since the bacteria work best when undisturbed, you don't have to clean it for the entire season. Even better, your Biological Filter and Falls makes it easy to find that balance by helping to aerate the water as it flows over the waterfall lip and by providing a great spot to place floating plants – right in the top of the Biological Filter and Falls itself. The Pro1000 Biological Filter and Falls can handle water flows from 250 to 950 gallons per hour (GPH) and the Pro2000 Biological Filter and Falls can handle water flows from 950 to 2000 gallons per hour so they work with a great variety of pump sizes.



ELECTRICAL PRECAUTIONS

Always use a properly grounded outlet. Do not immerse the plug in water. **DO NOT REACH INTO THE WATER TO REMOVE THE PLUG. TURN OFF CIRCUIT FIRST.** A "drip loop" in the cords should be used. A "drip loop" is a loop in the cord below the level of the receptacle or plug that prevents water from traveling along the cord. The national Electric Code requires that a ground fault interrupter circuit (GFCI) be installed in every branch circuit supplying the fountain or pond equipment. Your dealer can supply GFCI units. **NEVER REMOVE GROUND PIN FROM PLUG.**

WARNING: FOR YOUR PROTECTION, ALWAYS UNPLUG THE UNIT FROM ITS POWER SOURCE BEFORE INSTALLING OR SERVICING. DO NOT REACH, REMOVE OR DISASSEMBLE BEFORE YOU DISCONNECT POWER.

3. LOCATION OPTIONS

Your Water Fall box can be placed anywhere around your pond – inside the liner or at the liner perimeter. Most of the time it is placed at the beginning of a stream. The important thing to remember is that all of the water coming out of the filter must stay within the pond liner to avoid water loss. For maximum circulation and aeration, your Water Fall box should be located on the side of the pond farthest from the pump location. Once you have determined the location of the filter, you should decide on the size of the pump that will feed it. You might want a lot of water movement in a rushing stream or powerful waterfall, or you may prefer a quieter flow or gentle trickle. Once you have decided on the effect you wish to achieve, you can choose the pump to suit.

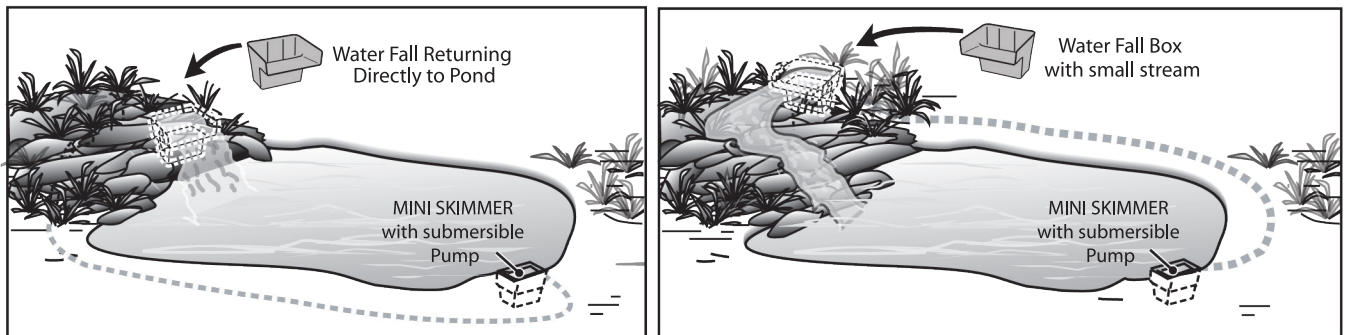

CHOOSING THE CORRECT PUMP

A good rule of thumb for garden ponds from 1000 to 2000 gallons is to circulate the entire volume of the pond every 1-2 hours to ensure good circulation while providing enough flow for an esthetically pleasing waterfall, stream or fountainhead. Your Water Fall box was therefore designed to perform well with pumps of 250 to 2000 GPH capacity.

We recommend our Pondmaster 250, 350, 500, 700 and 950 submersible pumps for smaller ponds under 1000 gallons; our 950, 1200, 1800 and 2000 gph pumps for greater flows and head heights.

See Pump Chart on next page.

PONDMASTER PUMP REFERENCE CHART

Pump	Item #	Gallons Per Hour							Shutoff-Head (ft.)	Watts Range*
		@ 0'	@ 1'	@ 3'	@ 5'	@ 7'	@ 10'	@ 15'		
Model 2	02522	360	270	204	78	0			7'	21 - 11
Model 3	02523	480	404	336	270	168			10'6"	37 - 16
Model 5	02525	570	480	426	324	204			10'6"	49 - 22
Model 7	02517	633	528	462	390	288	96		11'8"	60 - 32
Model 9.5	02720	975	780	738	684	612	450		12'10"	93 - 42
Model 12	02722	1200	972	882	798	714	588		13'6"	110 - 38
Model 18	02728	1375	1325	1200	1100	1050	875	575	16'10"	150 - 40
WFP 2000	02650	1650	1625	1300	1100	775	300		13'2"	140 - 75
HY-Drive 2000	02685	2350	2250	1875	1250	1100	750		15'0"	215-195

* Watts decrease as pump loads increase during normal usage. Examples show range from 0' to shut-off; watts continue to decrease as flow decreases.

FILTER and FALLS MEDIA SET-UP

If your waterfall includes filter media see the following steps.

For the Pro1000 and Pro2000 models with Debris Filter...
Flex the Debris Filter pad as shown and press into filter box. If after time the Debris filter is lifted by the water flow, either rinse and replace Debris Filter or replace with a new one.*

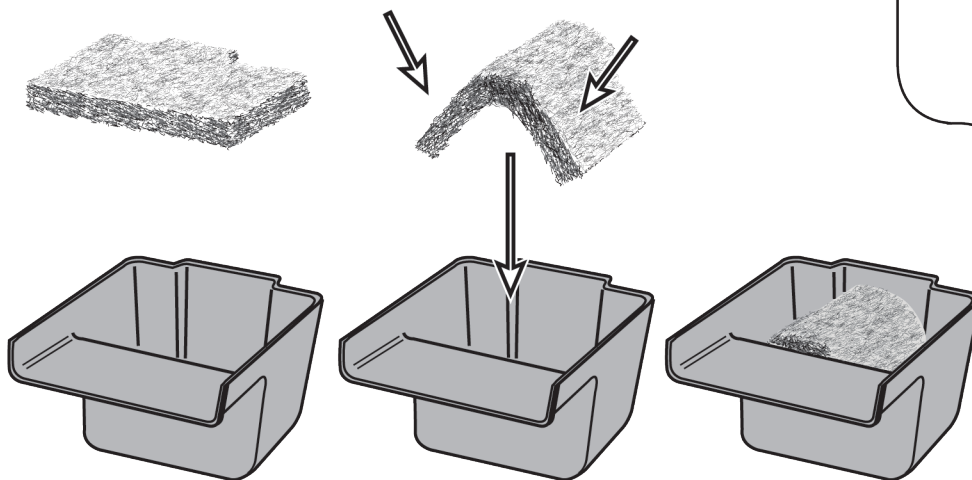

For the Pro1000 and Pro2000 models with BioMatrix Media ...
Simply place the media bag into the filter box.*
DO NOT OPEN THE MEDIA BAG.

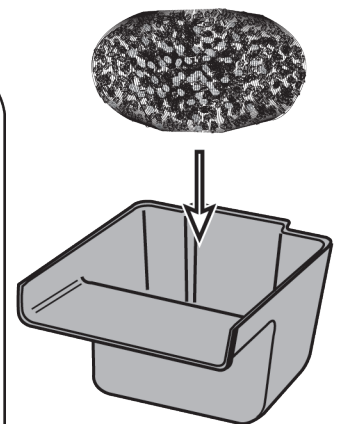

* Note that a flat stone can be placed on top of either style filter media to keep it down.

MAINTENANCE

The Pro1000 and Pro2000 Waterfalls require no maintenance other than periodically changing or refreshing the filter media in the models that include media.

FOR MODELS THAT INCLUDE FILTER MEDIA

Your Pro1000 and Pro2000 Waterfalls is a biological filter; it depends on an active colony of aerobic or oxygenating bacteria to remove ammonia from the water column. The colony will need 4 to 6 weeks to grow initially. After the bacteria have colonized the media, avoid rinsing the media in chlorinated water. Typical household tap water contains enough chlorine to wipe out the helpful bacterial colonies. Instead, clean the media by immersing the bag of media in bucket or small tub filled with pond water and briskly shaking to break up and remove some - but not all - of the sludge that builds up. This is typically necessary once at the end of the season. Note that the "dirty" water resulting from cleaning the filter media is good fertilizer for most outdoor plants.

DEBRIS FILTER PADS

The filter pads provided in the 02479 and 02469 Kits work as a debris filter and to a lesser extent a biological filter. The procedure above on how to clean the bagged filter media also applies to the debris filter pads. Note that depending on your particular pond conditions, cleaning may be needed more frequently. The Debris filter pad (Item # 12453 for Pro 1000 & Item # 12457 for Pro 2000) can be replaced as needed.

WINTERIZING

The Pro1000 and Pro2000 Waterfalls can withstand winter conditions unless you live where winters are extremely harsh. If the falls are turned off during the winter months, be sure to empty the falls and any tubing that is above ground since standing water will form ice that can split valves and rigid fittings.

REPLACEMENT PARTS

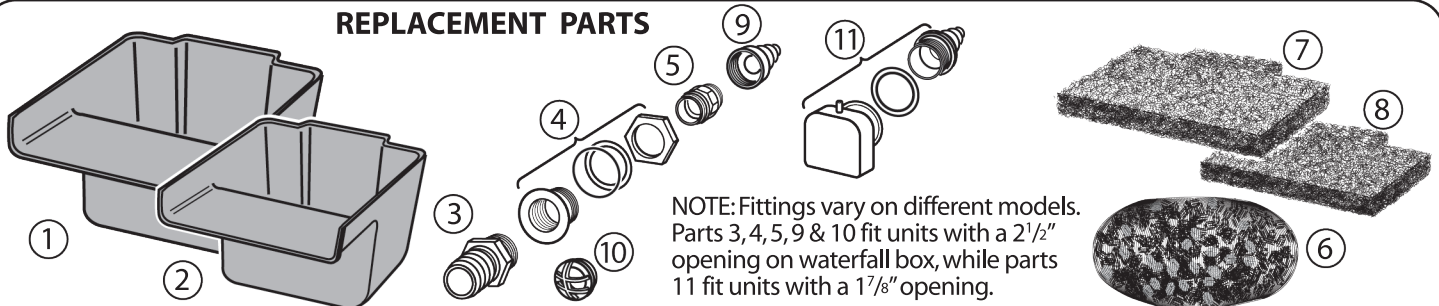

#	PART DESCRIPTION	INCLUDED WITH WATERFALL MODEL					
		# 02477	# 02478	# 02479	# 02467	# 02468	# 02469
①	2000 Waterfall Box	0	0	0	1	1	1
②	1000 Waterfall Box	1	1	1	0	0	0
③	1 1/2" MPT x barb fitting*	0	0	1	0	0	1
④	Bulkhead Fitting*	1	1	1	1	1	1
⑤	Tubing Fitting*	1	1	1	1	1	1
⑥	BioMatrix Media Bag	0	1	0	0	1	0
⑦	Debris Filter Pad 12457	0	0	0	0	0	1
⑧	Debris Filter Pad 12453	0	0	1	0	0	0
⑨	Multi-Barb Fitting*	1	1	1	1	1	1
⑩	Grate*	1	1	0	1	1	0

⑪ *Three piece Downspout w/ Multi-Barb Fitting replaces parts 3, 4, 5, 9 and 10 on some models (Those with 1 7/8" opening).

LIMITED ONE YEAR WARRANTY

E.G.Danner Manufacturing, Inc will repair or replace any Pro1000 or Pro2000 Waterfalls found to be defective within one year of original purchase. Wearable items are not covered by this warranty. For warranty repair, return only the part that is defective to our factory. Please include a dated proof of purchase and \$10.00 for postage and handling. Damages or injuries resulting from negligence or misuse of the product are not covered by this warranty. This warranty gives you specific legal rights. You may have other rights which vary from state to state.

DANNER MFG. INC. • 160 Oval Drive, Islandia, NY 11749-1489 (631) 234-5261
 Visit our website at www.Dannermfg.com